

| | |
|-----------------------------------|--|
| Site reference | R003 |
| Site name/address | Riverside Retail Park, Albion Way |
| Site size (Ha) | 7.05 |
| Suggested allocation | To continue to be allocated as a primary retail area, falling within the city centre retail area or equivalents, as to be defined by the site allocations development plan document. |
| Existing use | Class a1 retail centre, allocated as a primary retail area falling within the city centre retail area, both as defined by the <i>City of Norwich replacement local plan</i> . |
| Proposed by | Henderson Retail Warehouse Fund / Savills (L&P) Ltd |
| Planning status | The site is defined as Primary Retail Area in local plan Policy SHO10. Various planning permissions have been granted for construction of the retail park and its continued use. |
| Proposer's initial comment | <p>The site is located within Norwich's defined city centre and is an integral part of its overall attractiveness as a retail destination. The site also forms part of a wider established commercial, residential and leisure area known as the riverside area including large format leisure operations (cinema, bowling and health and fitness club); a significant number of restaurants, bars and nightclub venues; and a large number of residential dwellings. In addition, Norwich City Football Club's Carrow Road ground is located adjacent to the south eastern corner of the Retail Park.</p> <p>The riverside retail park is a well established destination within norwich city centre and is an important part of the city's overall retail provision and attraction. The park is easily accessible by a range of modes of transport and provides opportunities for linked trips between other commercial and residential land uses in and adjacent to the city centre.</p> |

Have your say

Do you agree, disagree or suggest changes to the proposed use(s) or boundary of the site and why?

** At this stage, Norwich City Council is not committed to any proposals as presented in this document. The inclusion of a site in this document does not represent any decision by the Council (unless a planning permission has already been granted). This consultation is to allow the public to have their say before detailed assessments are carried out.*

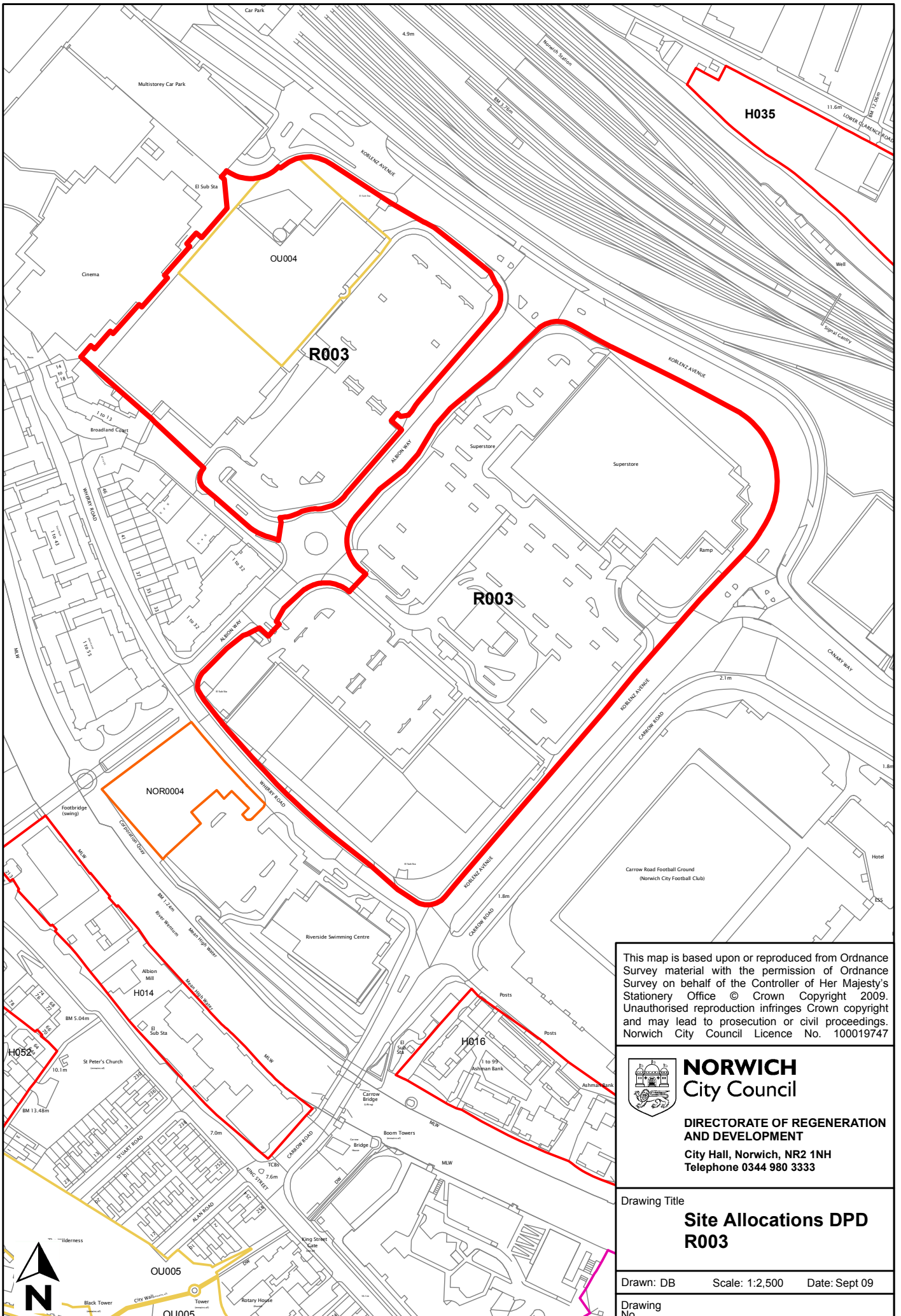

This map is based upon or reproduced from Ordnance Survey material with the permission of Ordnance Survey on behalf of the Controller of Her Majesty's Stationery Office © Crown Copyright 2009. Unauthorised reproduction infringes Crown copyright and may lead to prosecution or civil proceedings. Norwich City Council Licence No. 100019747

NORWICH
 City Council
 DIRECTORATE OF REGENERATION
 AND DEVELOPMENT
 City Hall, Norwich, NR2 1NH
 Telephone 0344 980 3333

Drawing Title
**Site Allocations DPD
 R003**

Drawn: DB Scale: 1:2,500 Date: Sept 09
 Drawing No.

