

Site reference	E002
Site name/address	Victoria House, Queens Road
Site size (ha)	2.58
Suggested allocation	Office extension with multi-storey car park (possibly include change of use to residential on part of site)
Existing use	Offices with ancillary surface parking
Proposed by	Marsh Corporate Services Limited
Planning status	Withdrawn planning application ref 4/2002/0321/F
Proposer's initial comment	The site is opposite the bus station and surrounded by roads on three sides, with a residential area at the rear. A tree survey has been undertaken.

Have your say

Do you agree, disagree or think there should be changes to the proposed uses and boundary of the site? Please give reasons.

Norwich City Council is not committed to any proposals in this document. The inclusion of a site in this document does not represent a decision by the council unless planning permission has already been granted.

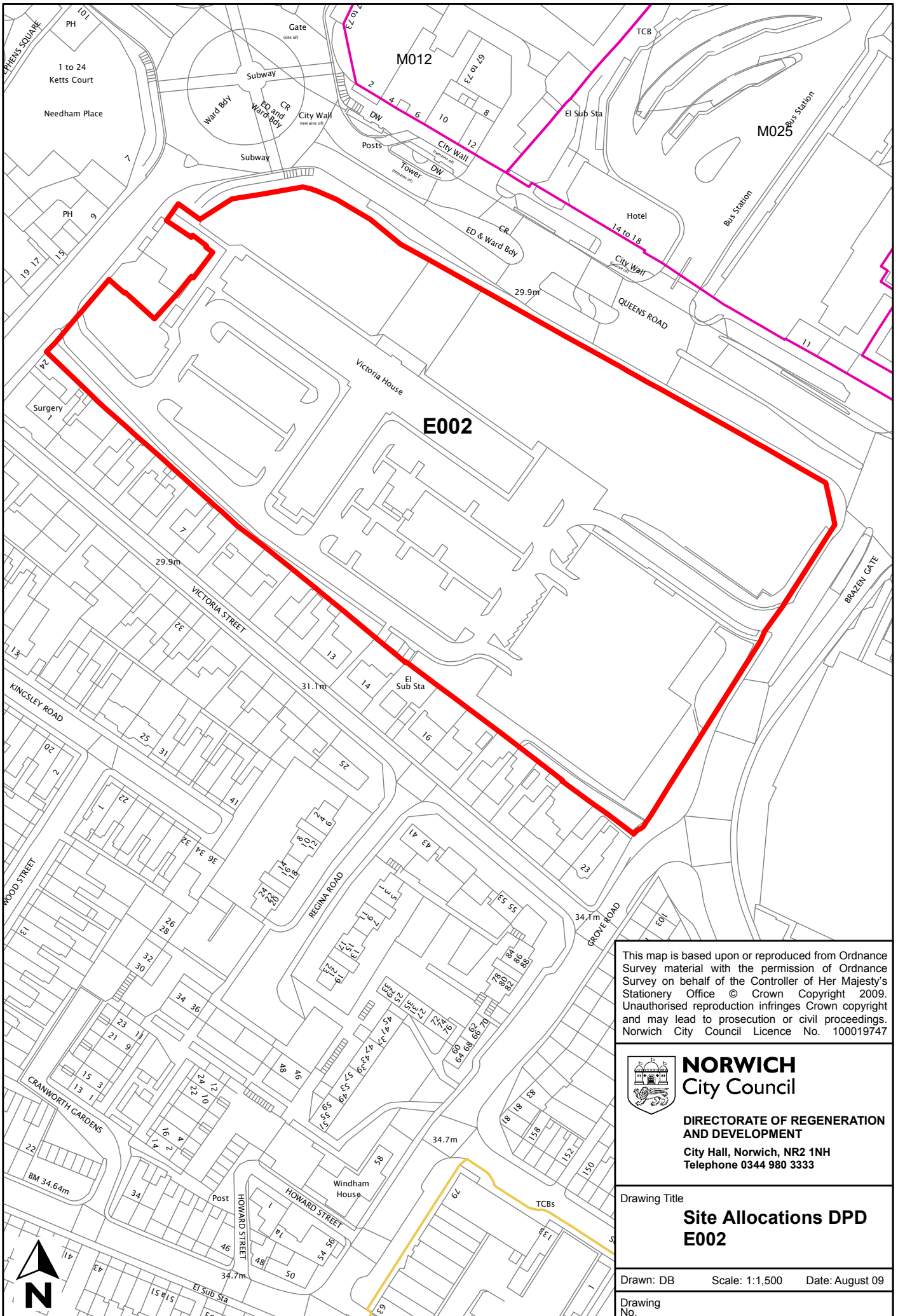

This map is based upon or reproduced from Ordnance Survey material with the permission of Ordnance Survey on behalf of the Controller of Her Majesty's Stationery Office © Crown Copyright 2009. Unauthorised reproduction infringes Crown copyright and may lead to prosecution or civil proceedings. Norwich City Council Licence No. 100019747

NORWICH
 City Council
 DIRECTORATE OF REGENERATION
 AND DEVELOPMENT
 City Hall, Norwich, NR2 1NH
 Telephone 0344 980 3333

Drawing Title
**Site Allocations DPD
 E002**

Drawn: DB Scale: 1:1,500 Date: August 09
 Drawing No.